

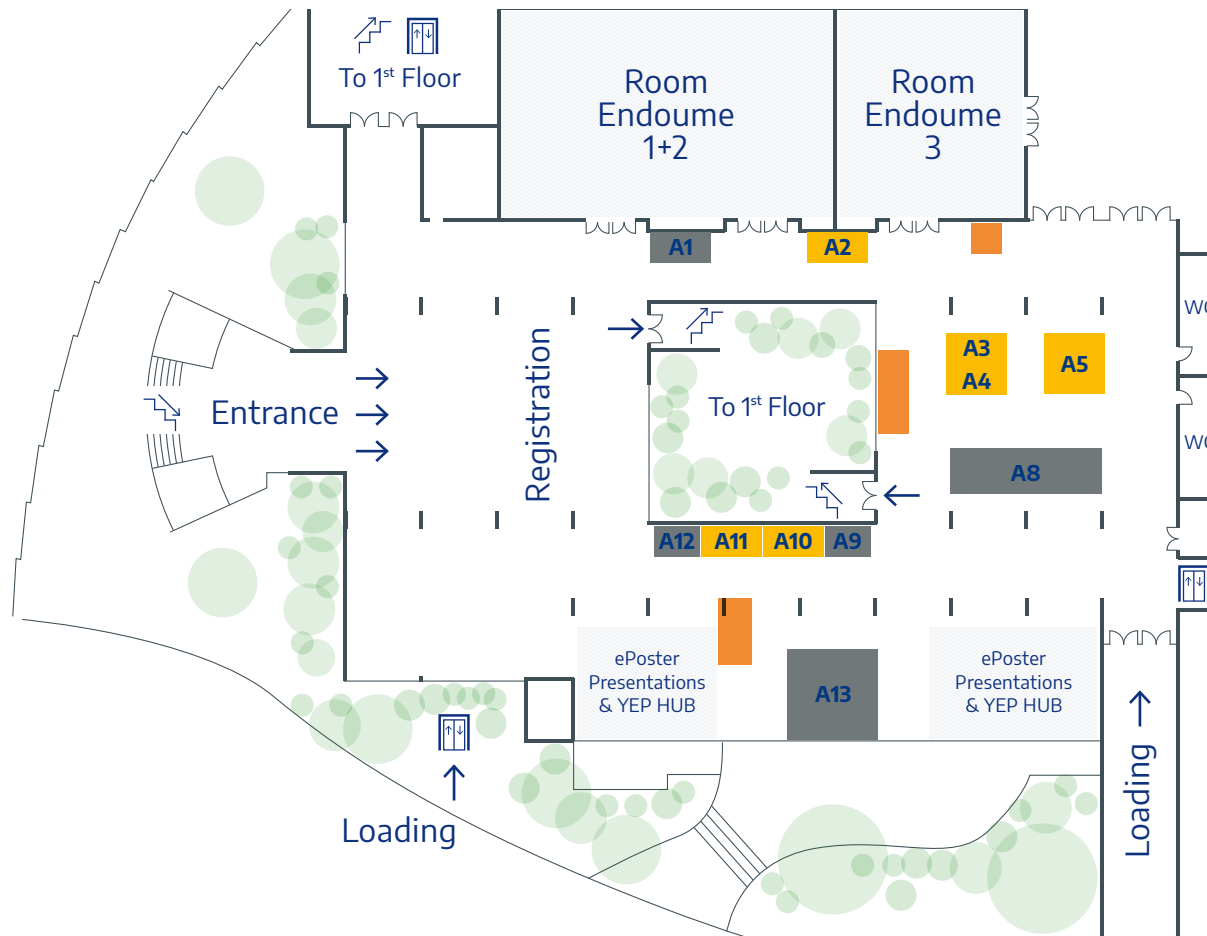

## Layout Exhibition Area · Palais des Congrès Garden Level

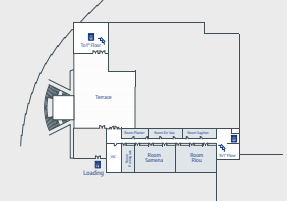

2<sup>nd</sup> Floor



1<sup>st</sup> Floor

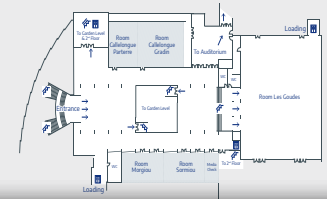

Garden Level



Exhibition spaces available to book

Booked exhibition space

Amenities

Columns / pillars

Layout not to scale.



## Layout Exhibition Area · Palais des Congrès 1<sup>st</sup> Floor

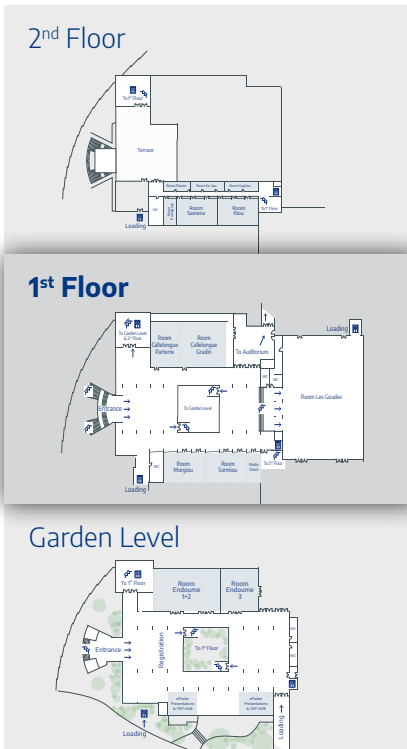
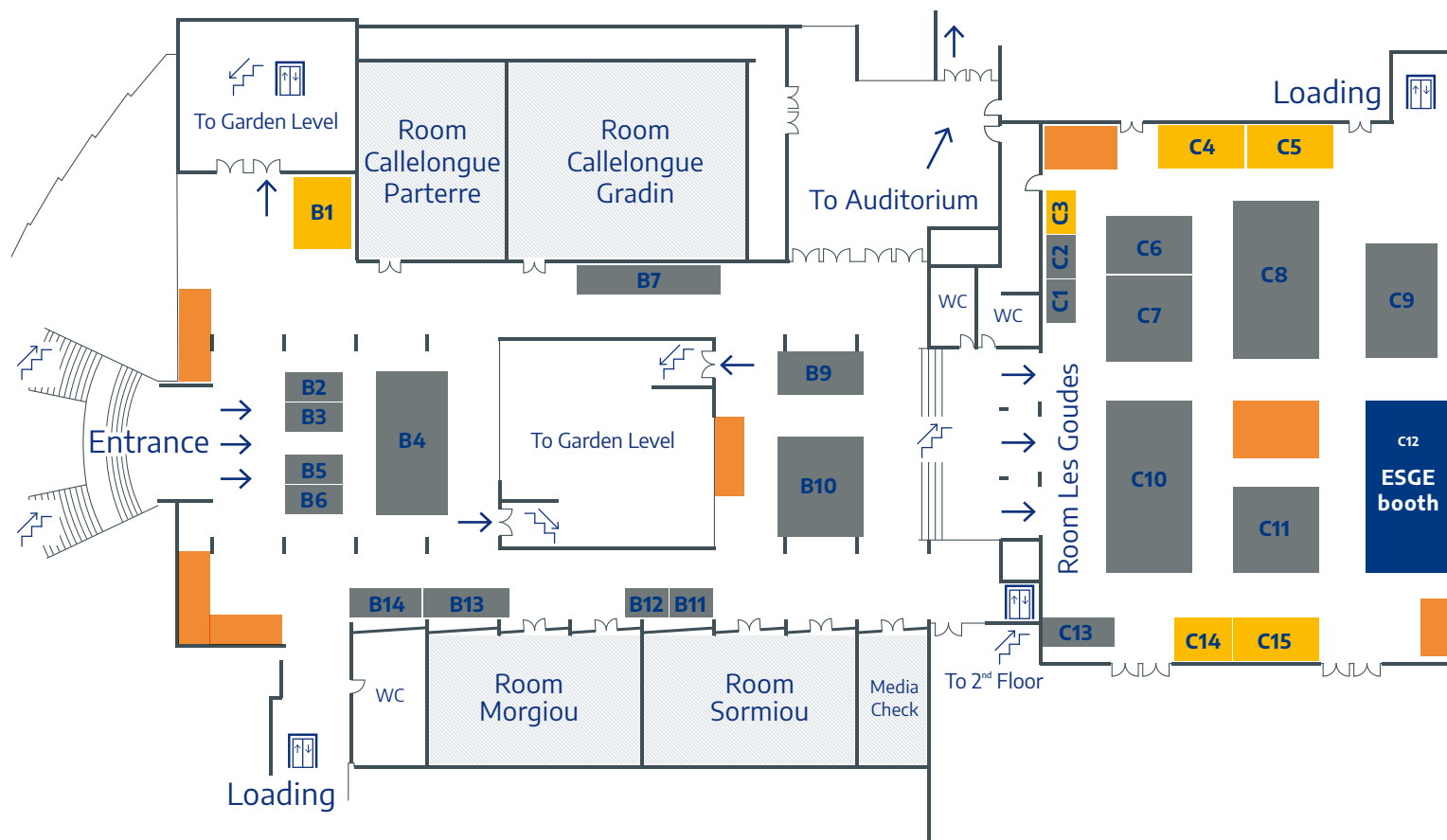

- Exhibition spaces available to book
  - Booked exhibition space
  - Service areas
  - Columns / pillars
- Layout not to scale.



## Layout Exhibition Area · Palais des Congrès Garden Level

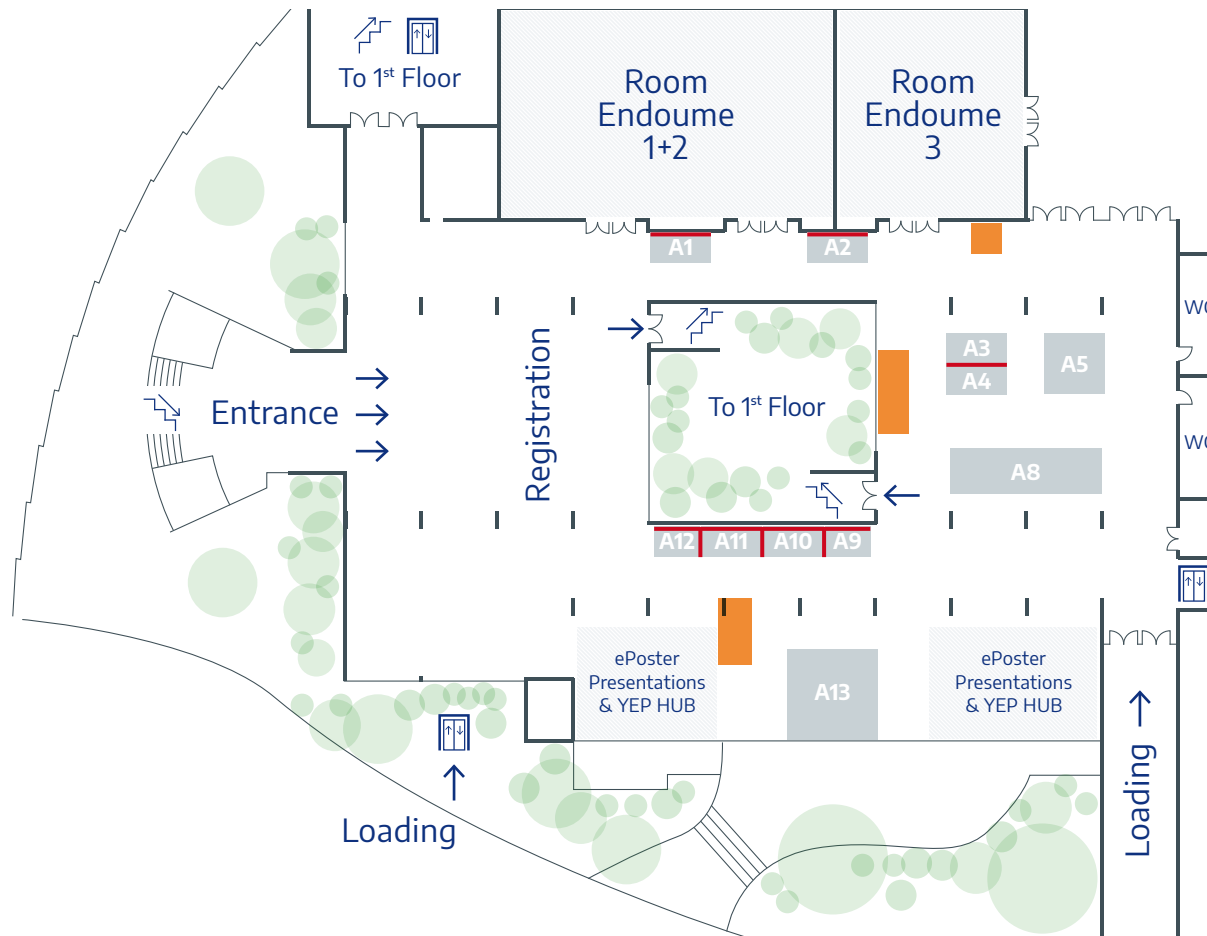

2<sup>nd</sup> Floor

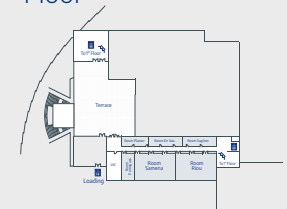

1<sup>st</sup> Floor

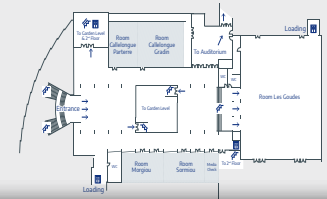

Garden Level



Columns / pillars  
Layout not to scale.

Mandatory walls

Optional walls



## Layout Exhibition Area · Palais des Congrès 1<sup>st</sup> Floor

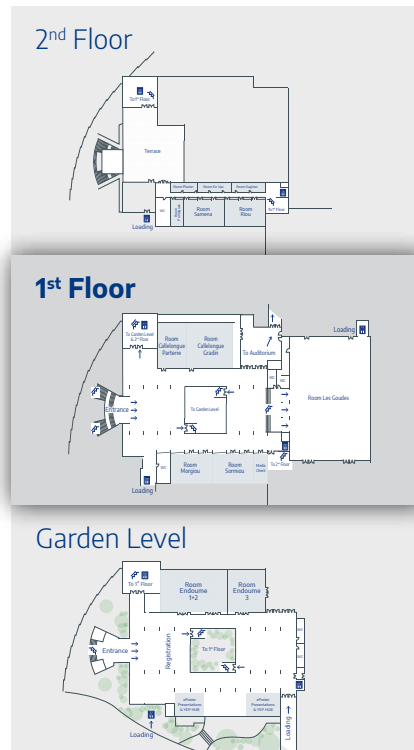
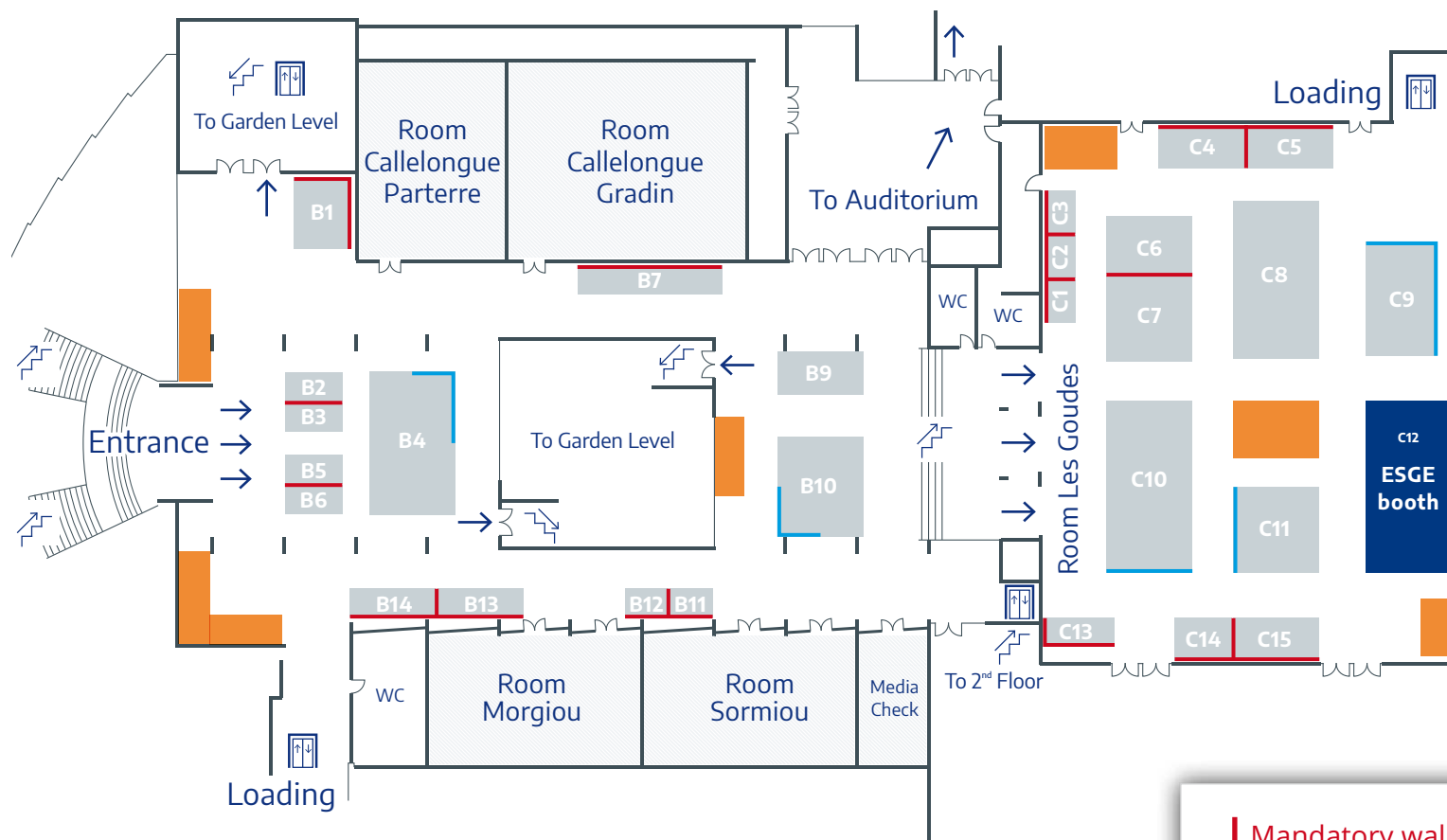

— Mandatory walls  
— Optional walls



## Dimensions

### Garden level

Exhibition number	Exhibition size	Width	Depth	Maximum construction height	Rigging possible
A1	6 m <sup>2</sup>	3 m	2 m	2,5 m	No
A2	8 m <sup>2</sup>	4 m	2 m	2,5 m	No
A3	8 m <sup>2</sup>	4 m	2 m	2,5 m	No
A4	8 m <sup>2</sup>	4 m	2 m	2,5 m	No
A5	16 m <sup>2</sup>	4 m	4 m	2,5 m	No
A8	30 m <sup>2</sup>	10 m	3 m	2,5 m	No
A9	6 m <sup>2</sup>	3 m	2 m	2,5 m	No
A10	8 m <sup>2</sup>	4 m	2 m	2,5 m	No
A11	8 m <sup>2</sup>	4 m	2 m	2,5 m	No
A12	6 m <sup>2</sup>	3 m	2 m	2,5 m	No
A13	36 m <sup>2</sup>	6 m	6 m	2,5 m	No

### First Floor

Exhibition number	Exhibition size	Width	Depth	Maximum construction height	Rigging possible
B1	20 m <sup>2</sup>	4 m	5 m	3 m	No
B2	8 m <sup>2</sup>	4 m	2 m	2,5 m	No
B3	8 m <sup>2</sup>	4 m	2 m	2,5 m	No
B4	50 m <sup>2</sup>	10 m	5 m	3 m	No
B5	8 m <sup>2</sup>	4 m	2 m	2,5 m	No
B6	8 m <sup>2</sup>	4 m	2 m	2,5 m	No
B7	20 m <sup>2</sup>	10 m	2 m	2,5 m	No
B9	18 m <sup>2</sup>	6 m	3 m	2,5 m	No
B10	42 m <sup>2</sup>	6 m	7 m	3 m	No
B11	6 m <sup>2</sup>	3 m	2 m	2,5 m	No
B12	6 m <sup>2</sup>	3 m	2 m	2,5 m	No
B13	12 m <sup>2</sup>	6 m	2 m	2,5 m	No
B14	10 m <sup>2</sup>	5 m	2 m	2,5 m	No

### Les Goudes

Exhibition number	Exhibition size	Width	Depth	Maximum construction height	Rigging possible
C1	6 m <sup>2</sup>	3 m	2 m	2,5 m	No
C2	6 m <sup>2</sup>	3 m	2 m	2,5 m	No
C3	6 m <sup>2</sup>	3 m	2 m	2,5 m	No
C4	18 m <sup>2</sup>	6 m	3 m	5 m	No
C5	18 m <sup>2</sup>	6 m	3 m	5 m	No
C6	24 m <sup>2</sup>	6 m	4 m	3 m	See note*
C7	36 m <sup>2</sup>	6 m	6 m	3 m	See note*
C8	66 m <sup>2</sup>	11 m	6 m	4 m	See note*
C9	40 m <sup>2</sup>	8 m	5 m	5 m	See note*
C10	72 m <sup>2</sup>	12 m	6 m	3 m	See note*
C11	36 m <sup>2</sup>	6 m	6 m	4 m	See note*
ESGE	72 m <sup>2</sup>	12 m	6 m	5 m	See note*
C13	10 m <sup>2</sup>	5 m	2 m	2,5 m	No
C14	12 m <sup>2</sup>	4 m	3 m	5 m	No
C15	18 m <sup>2</sup>	6 m	3 m	5 m	No

**Important:** see pages 3 and 4 for mandatory walls.

\*partial rigging may be possible depending on requirements.  
Larger / complex rigging designs may be subject to additional fees.